

KOFLow

CHECK VALVE SERIES

43-71P

FIGURE NUMBER SYSTEM

Check Valve Figure Number System

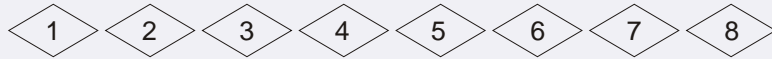

1	Size	Xxin; xx, mm						
2	Operation type	Not suitable						
3	Valve Type	H-Check Valve						
4	Pressure	0-PN10	1-PN16 class150	2-PN25	3-class300	4-PN40 class400	6-PN64 class600	
		9-class900	10-PN100	15-class1500	16-PN160	20-PN200	25-class2500	
5	Connection Ends	RF-Raised Face	FF Flat Face	MFM Male and Female Face		TG Tongue and Groove face		
		RJ Ring Joint		BW Butt weld		WF-Wafer Type		
6	Structure Type	1-Lift Type		4-Single Disc Swing type		6-Double Disc Swing type		7-Tilting Disc Type
7	Basic Material	C-WCB	C-C5	C6-WC6	C9-WC9	BL-LCB		CL-LCC
		8-CF8	8M-CF8M	3-CF3	3M-CF3M	ML-MONEL		
8	Material of Seat face or Liner	H-Cr13 S.S			E-18-8 S.S		R-Mo2Ti S.S	
		D- nitriding steel			M- Monel Alloy		Y-Stellited	

Note:

- 1、 Use "W" to express seat sealing surface material which is processed directly by valve body.
- 2、 When the materials of sealing surface are different, use low hardness material symbol to express
- 3、 Special Requirements not shown ,should be indicated in the purchase order
- 4、 The models listed in the sample book have no reference to pressure、 sizes and valve material symbols, they are to be decided by users.

For example

8 " -H1RF4CH

Check valve, 8 " ANSI CLASS150, Raised Face Ends, Single Disc Swing type, Body&Bonnet&Disc Cast Steel WCB, Seat sealing face material 13Cr

50-H2WF68W

Check valve, DN80 PN25, Wafer type, Double Disc Swing type, Body&Bonnet&Disc Stainless Steel CF8, Seat sealing face Body machined.

DOUBLE-DISC WAFER TYPE CHECK VALVE

Design of Double-Plate Wafer Type Check Valve

Material List For Main Parts

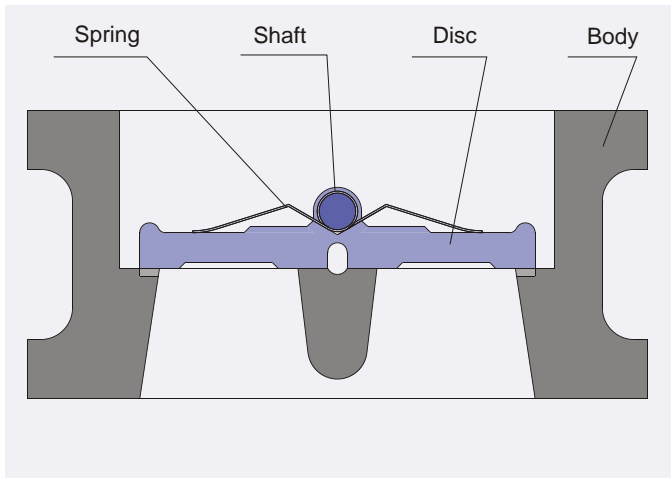

No.	Part name	ASTM		
		Carbon Steel	Stainless Steel	Alloy Steel
1	Body	A216 WCB	A351 CF8	A217 WC6
2	Disc	A351 CF8	A351 CF8	A351 CF8
3	Spring	A182 F304	A182 F304	A182 F304
4	Bonnet	A182 F6a	A182 F304	A182 F304

No.	Part name	GB		
		Carbon Steel	Stainless Steel	Alloy Steel
1	Body	WCB	CF8	WC6
2	Disc	CF8	CF8	CF8
3	Spring	0Cr18Ni9	0Cr18Ni9	0Cr18Ni9
4	Bonnet	1Cr13	0Cr18Ni9	0Cr18Ni9

Remark:

- 1、 Select different materials for different working temperature and media

Double-Plate Wafer Type Check Valve

Nominal pipe size		Liquid resistance coefficient of the valves full open	water flowing coefficient of the valves full open under nominal temperature			Flowing direction	
DN	NPS		Kv(m ³ /h)	Cv(U.S)	Cv(U.K)	Vertical ↑	horizontal →
50	2	2.6	63	74	62	2	1
65	2 1/2	2.4	109	128	107	2	1
80	3	2.3	172	201	169	2	1
100	4	2	289	338	283	2	1
125	5	1.8	476	557	466	2	1
150	6	1.5	750	878	735	2	1
200	8	1.3	1432	1675	1403	2	1
250	10	1.2	2330	2726	2283	2	1
300	12	1	3676	4301	3602	2	1
350	14	0.9	5274	6171	5169	2	1
400	16	0.8	7306	8548	7160	3	1
450	18	0.8	9246	10818	9061	3	1
500	20	0.8	11415	13356	11187	3	1
600	24	0.7	17573	20560	17222	3	1
700	28	0.7	23919	27985	23441	4	1
750	30	0.7	27458	32126	26909	4	1
800	32	0.7	31241	36552	30616	4	1
900	36	0.7	39539	46261	38748	4	1
1000	40	0.7	48814	57112	47838	4	1
1050	42	0.7	53817	62966	52741	4	1
1100	44	0.7	—	—	—	4	1
1200	48	0.7	70292	82242	68886	4	1
1350	54	0.7	—	—	—	4	1
1400	56	0.7	—	—	—	4	1
1500	60	0.7	—	—	—	4	1

DOUBLE-DISC WAFER TYPE CHECK VALVE

Comparison between Wafer Check Valve and Flange Single-disc Swing Check Valve

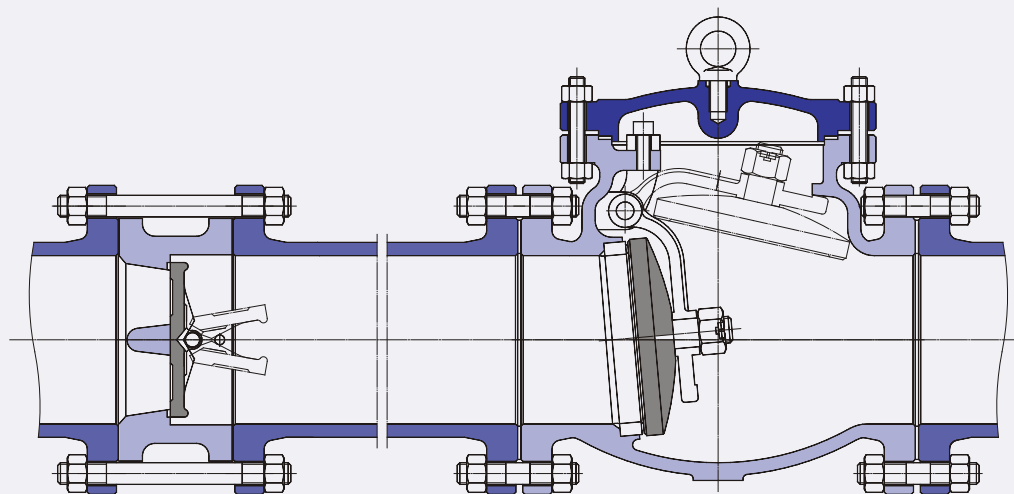

H76 Wafer Bi-disc Check Valve

H44 Flange Single-disc Check Valve

Structure Form	H76 Dual Disc Wafer Swing Check Valves	H44 Single Disc Flanged Swing Check Valves
Water hammer pressure	Small, Short disc travel and Spring assistant can make the valves move more quickly to the closed position	Heavy, Long disc travel result in the valves need more closing time
	H76 type check valves, its water hammer pressure is only 1/2~1/5 of that H44 type	
Size and Weight	All of the short face to face dimension, small volume and light weight are result in the convenience of valves installation, transit, storage and pipe disposal and saving in initial material and cost.	The valves are long face to face dimension, large volume and heavy weight
	Face to face dimension of H76 is only 1/4~1/6 of that of H44 and the weight of H76 is only 1/4~1/10 of that H44	
Liquid Resistance	Small, Liquid resistance coefficient of the valves is 2.6~0.7 which will reduce along with the accretion of the valves nominal diameter	Small, Liquid resistance coefficient of the valves is 1.3~3. Under low pressure working conditions the disc can not full open and the liquid resistance coefficient is large. The liquid resistance will increase along with the accretion of valves nominal diameter
Installation	Both vertical installation and horizontal installation are optional. Lighter weight will make the valves without support.	Both vertical installation and horizontal installation are optional. Heavy weight of large bore valves should set with seat.
Opening pressure	Small, the disc can full open under less pressure difference	Heavy, the disc will full open only under large pressure difference
Reliability	The valves with unitary simple frame have little impact force during closing. It gets small water hammer pressure, long usage life and high reliability	Large impact force and water hammer pressure will damage the valves during closing

DOUBLE-DISC WAFER TYPE CHECK VALVE

Double-Plate Wafer Type Check Valve Product Line

Size		Pressure(CLASS)																
		API SERIES (CLASS)						JIS SERIES		GB SERIES (PN)								
DN	NPS	150	300	600	900	1500	2500	10K	20K	1.0	1.6	2.5	4.0	6.4	10.0	16.0	20.0	25.0
50	2	*	*	*	*	*	*	*	*	*	*	*	*	*	*	*	*	*
65	2-1/2	*	*	*	*	*	*	*	*	*	*	*	*	*	*	*	*	*
80	3	*	*	*	*	*	*	*	*	*	*	*	*	*	*	*	*	*
100	4	*	*	*	*	*	*	*	*	*	*	*	*	*	*	*	*	*
125	5	*	*	*	*	*	*	*	*	*	*	*	*	*	*	*	*	*
150	6	*	*	*	*	*	*	*	*	*	*	*	*	*	*	*	*	*
200	8	*	*	*	*	*	*	*	*	*	*	*	*	*	*	*	*	*
250	10	*	*	*	*	*	*	*	*	*	*	*	*	*	*	*	*	*
300	12	*	*	*	*	*	*	*	*	*	*	*	*	*	*	*	*	*
350	14	*	*	*	*	*	*	*	*	*	*	*	*	*	*	*	*	*
400	16	*	*	*	*	*	*	*	*	*	*	*	*	*	*	*	*	*
450	18	*	*	*	*	*	*	*	*	*	*	*	*	*	*	*	*	*
500	20	*	*	*	*	*	*	*	*	*	*	*	*	*	*	*	*	*
600	24	*	*	*	*	*	*	*	*	*	*	*	*	*	*	*	*	*
650	26	*	*	*	*	*	*	*	*	*	*	*	*	*	*	*	*	*
700	28	*	*	*	*	*	*	*	*	*	*	*	*	*	*	*	*	*
750	30	*	*	*	*	*	*	*	*	*	*	*	*	*	*	*	*	*
800	32	*	*	*	*	*	*	*	*	*	*	*	*	*	*	*	*	*
900	36	*	*	*	*	*	*	*	*	*	*	*	*	*	*	*	*	*
1000	40	*	*	*	*	*	*	*	*	*	*	*	*	*	*	*	*	*
1050	42	*	*	*	*	*	*	*	*	*	*	*	*	*	*	*	*	*
1100	42	*	*	*	*	*	*	*	*	*	*	*	*	*	*	*	*	*
1200	48	*	*	*	*	*	*	*	*	*	*	*	*	*	*	*	*	*
1350	54	*	*	*	*	*	*	*	*	*	*	*	*	*	*	*	*	*
1400	56	*	*	*	*	*	*	*	*	*	*	*	*	*	*	*	*	*
1500	60	*	*	*	*	*	*	*	*	*	*	*	*	*	*	*	*	*

Technical Specification

Design Standard	API6D、API594	JIS B2071	GB/T 12221				
Pressure-Temperature Rating	ASME B16.34	/	GB/T 12224				
Face-Face	API6D、API594	JIS B2002	Factory Standard				
Flange Ends	ASME B16.5、ASME B16.47	JIS 2210	GB/T9113 、 JB/T79				
Inspection &Test	API598、API6D	JIS B2003	JB/T9092 、 GB/T13927				
Test Pressure	Norminal Pressure	150 300 600 900 1500 2500	10K 20K 1.0 1.6 2.5 4.0 6.4 10.0 16.0 20.0 25.0				
	Shell Test	2.93 7.55 10.0 15.0 37.5 63.0	2.35 5.0 2.0 2.4 3.75 6.0 9.6 15.0 24.0 30.0 37.5				
	High Pressure Seal Test	2.07 5.52 7.31 11.03 27.5 46.2	1.47 3.67 1.1 1.76 2.75 4.4 7.04 11.0 17.6 22.0 27.5				
	Low Pressure Seal Test	0.6					
Applicable Temperature	-196℃ ~ 550℃ (Different raw material for different work temperature)						
Applicable Medium	Water, oil, gas and other causticity medium (Different raw material for different medium)						

DOUBLE-DISC WAFER TYPE CHECK VALVE

API SERIES CLASS150

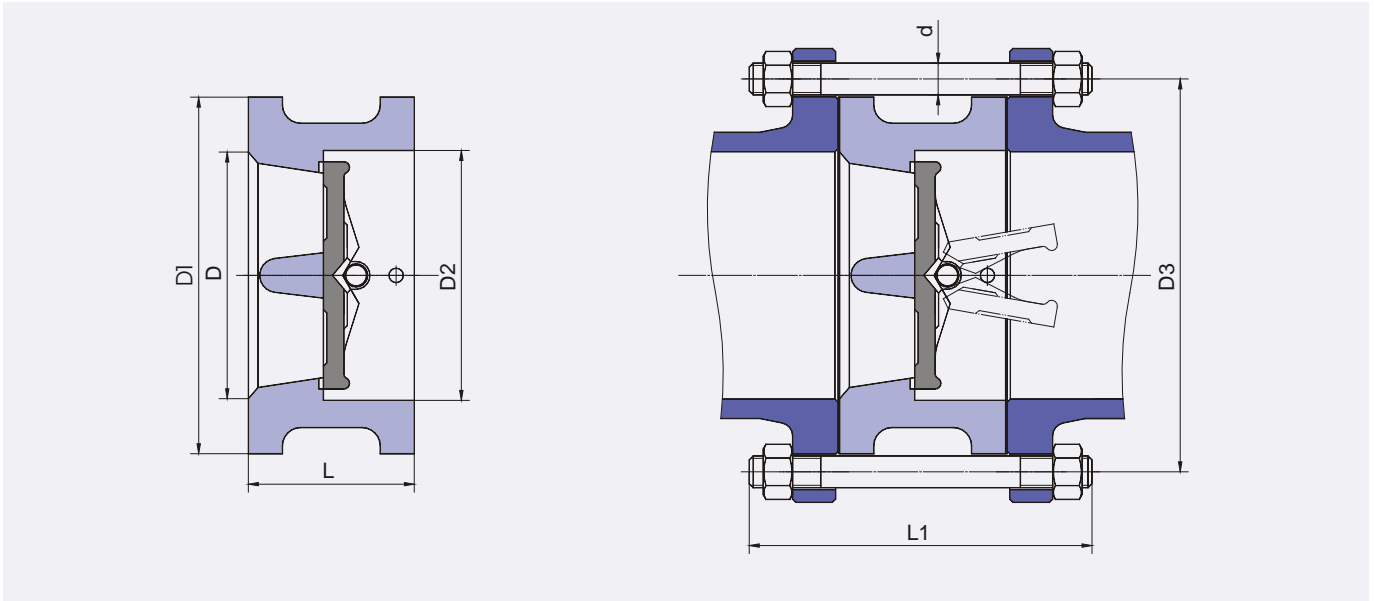

Main Dimensions & Weight

CLASS150 PN2.0

Pressure / Flange standard	Nominal pipe size		Dimension				Weight (kg)	Pipe Flange					
	NPS	DN	L	D1	D2	D		D3	Bolt No.	Stud Dia (d)		Stud Length (L1)	
										in	mm	RF	RJ
CLASS150 PN2.0/ ASME B16.5	2	50	60	103	56	51	2	120.5	4	5/8	M16	140	155
	2 1/2	65	67	122	73	65	3	139.5	4	5/8	M16	150	165
	3	80	73	135	88	80	4	152.5	4	5/8	M16	160	175
	4	100	73	173	108	102	6	190.5	8	5/8	M16	170	185
	5	125	86	195	132	127	8	216	8	3/4	M20	190	205
	6	150	98	220	160	152	13	241.5	8	3/4	M20	205	220
	8	200	127	277	210	203	25	298.5	8	3/4	M20	240	255
	10	250	146	337	266	254	39	362	12	7/8	M24	270	285
	12	300	181	407	310	305	54	432	12	7/8	M24	310	325
	14	350	184	448	355	350	80	476	12	1	M27	325	340
	16	400	191	512	405	400	117	540	16	1	M27	340	355
	18	450	203	547	455	450	138	578	16	1 1/8	M30	365	380
	20	500	219	604	505	500	163	635	20	1 1/8	M30	385	400
	24	600	222	715	605	600	331	749.5	20	1 1/4	M33	405	420
CLASS150 PN2.0/ ASME B16.47A, MSS SP-44	26	650	222	770	650	633	380	806.5	24	1 1/4	M33	450	—
	28	700	305	827	700	700	400	863.5	28	1 1/4	M33	535	—
	30	750	305	878	750	746	440	914.5	28	1 1/4	M33	545	—
	32	800	305	935	800	796	580	978	28	1 1/2	M39×3	570	—
	36	900	368	1045	894	874	660	1086	32	1 1/2	M39×3	650	—
	40	1000	432	1167	985	976	890	1200	36	1 1/2	M39×3	710	—
	42	1050	432	1213	1055	1050	980	1257.5	36	1 1/2	M39×3	730	—
	44	1100	432	1274	1070	1070	1150	1314.5	40	1 1/2	M39×3	730	—
	48	1200	524	1397	1205	1166	1450	1422.5	44	1 1/2	M39×3	840	—
	54	1350	591	1545	1315	1312	2300	1594	44	1 3/4	M45×3	950	—
	56	1400	591	1602	1370	1360	2800	1651	48	1 3/4	M45×3	955	—
	60	1500	660	1701	1470	1458	3220	1759	52	1 3/4	M45×3	1040	—

DOUBLE-DISC WAFER TYPE CHECK VALVE

API SERIES CLASS300

Main Dimensions & Weight

CLASS300 PN5.0

Pressure / Flange standard	Nominal pipe size		Dimension				Weight (kg)	Pipe Flange					
	NPS	DN	L	D1	D2	D		D3	Bolt No.	Stud Dia (d)		Stud Length (L1)	
										in	mm	RF	RJ
CLASS300 PN5.0/ ASME B16.5	2	50	60	110	58	51	3	127	8	5/8	M16	155	175
	2 1/2	65	67	128	73	65	4	149	8	3/4	M20	175	195
	3	80	73	147	88	80	6	168.5	8	3/4	M20	190	210
	4	100	73	179	108	102	8	200	8	3/4	M20	195	215
	5	125	86	214	132	127	15	235	8	3/4	M20	215	235
	6	150	98	249	160	152	18	270	12	3/4	M20	230	250
	8	200	127	305	210	203	31	330	12	7/8	M24	280	300
	10	250	146	359	266	254	51	387.5	16	1	M27	315	335
	12	300	181	420	310	305	77	451	16	1 1/8	M30	365	385
	14	350	222	483	355	350	117	514.5	20	1 1/8	M30	410	430
	16	400	232	537	405	400	190	571.5	20	1 1/4	M33	435	455
	CLASS300 PN5.0/ ASME B16.47B、 API605	18	450	264	594	455	450	200	628.5	24	1 1/4	M33	475
20		500	292	652	505	500	265	686	24	1 1/4	M33	510	535
24		600	318	772	608	600	410	813	24	1 1/2	M39×3	560	585
26		650	356	767	640	633	560	803	32	1 1/4	M33	625	—
28		700	368	821	985	685	580	857	36	1 1/4	M33	635	—
30		750	368	882	740	735	660	921	36	1 3/8	M36×3	650	—
32		800	368	936	784	784	970	978	32	1 1/2	M39×3	675	—
36		900	483	1044	880	873	1010	1089	32	1 5/8	M42×3	800	—
40		1000	546	1146	985	976	1420	1191	40	1 5/8	M42×3	885	—
42		1050	568	1196	1045	1035	1540	1244.5	36	1 3/4	M45×3	920	—
48		1200	629	1365	1190	1166	2250	1416	40	1 7/8	M48×3	1010	—
54		1350	718	1526	1315	1312	3100	1578	48	1 7/8	M48×3	1140	—
60	1400	838	1704	1470	1458	4310	1764	40	2 1/4	M56×3	1280	—	
CLASS300 PN5.0/ ASME B16.47A、 MSSSP-44	26	650	356	831	640	633	580	876	28	1 5/8	M42×3	625	—
	28	700	368	895	985	685	600	940	28	1 5/8	M42×3	650	—
	30	750	368	949	740	735	680	997	28	1 3/4	M45×3	665	—
	32	800	368	1003	784	784	990	1054	28	1 7/8	M48×3	685	—
	36	900	483	1113	880	873	1050	1168.5	32	2	M52×3	820	—
	40	1000	546	1110	985	976	1400	1156	32	1 5/8	M42×3	885	—
	42	1050	568	1161	1045	1035	1520	1206.5	32	1 5/8	M42×3	915	—
	48	1200	629	1320	1190	1166	2250	1371.5	32	1 7/8	M48×3	1015	—
	54	1350	718	1489	1315	1312	3050	1549.5	28	2 1/4	M56×3	1160	—
	60	1400	838	1642	1470	1458	4300	1702	32	2 1/4	M56×3	1305	—

DOUBLE-DISC WAFER TYPE CHECK VALVE

API SERIES CLASS600

Main Dimensions & Weight

CLASS600 PN11.0

Pressure / Flange standard	Nominal pipe size		Dimension				Weight (kg)	Pipe Flange					
	NPS	DN	L	D1	D2	D		D3	Bolt No.	Stud Dia (d)		Stud Length (L1)	
										in	mm	RF	RJ
CLASS600 PN11.0/ ASME B16.5	2	50	60	110	58	51	4	127	8	5/8	M16	175	180
	2 1/2	65	67	128	73	65	5	149	8	3/4	M20	195	200
	3	80	73	147	88	80	8	168.5	8	3/4	M20	210	215
	4	100	79	191	108	102	11	216	8	7/8	M24	235	240
	5	125	105	239	136	127	20	267	8	1	M27	280	285
	6	150	136	264	162	152	26	292	12	1	M27	320	325
	8	200	165	318	212	200	55	349	12	1 1/8	M30	370	375
	10	250	213	398	266	250	95	432	16	1 1/4	M33	440	445
	12	300	229	455	312	305	140	489	20	1 1/4	M33	460	465
	14	350	273	490	355	337	223	527	20	1 3/8	M36 × 3	520	525
	16	400	305	562	400	387	360	603	20	1 1/2	M39 × 3	575	580
	18	450	362	610	450	438	395	654	20	1 5/8	M42 × 3	650	655
	20	500	368	680	500	489	518	724	24	1 5/8	M42 × 3	670	680
CLASS600 PN11.0/ ASME B16.47B、 API605	24	600	438	786	600	591	836	838	24	1 7/8	M48 × 3	780	790
	26	650	457	761	640	633	950	806.5	28	1 5/8	M42 × 3	790	805
	28	700	483	815	690	684	1210	863.5	28	1 3/4	M45 × 3	830	845
	30	750	505	875	740	735	1370	927	28	1 7/8	M48 × 3	875	890
	32	800	533	928	784	779	1640	984	28	2	M52 × 3	920	940
CLASS600 PN11.0/ ASME B16.47A、 MSSSP-44	36	900	635	1045	880	874	2120	1105	28	2 1/4	M56 × 3	1065	1085
	26	650	457	863	640	633	980	914.5	28	1 7/8	M48 × 3	795	810
	28	700	483	910	690	684	1250	965	28	2	M52 × 3	835	850
	30	750	505	967	740	735	1420	1022.5	28	2	M52 × 3	860	905
	32	800	533	1020	784	779	1700	1079.5	28	2 1/4	M56 × 3	905	925
	36	900	635	1126	880	874	2200	1194	28	2 1/2	M64 × 3	1035	1055
	40	1000	660	1153	985	976	2650	1213	32	2 1/4	M56 × 3	1115	—
42	1050	702	1215	1030	1020	3120	1283	28	2 1/2	M64 × 3	1190	—	
48	1200	787	1386	1170	1166	3720	1460.5	32	2 3/4	M70 × 3	1330	—	

DOUBLE-DISC WAFER TYPE CHECK VALVE

API SERIES CLASS900~2500

Main Dimensions & Weight

CLASS900~2500 PN15.0~42.0

Pressure / Flange standard	Nominal pipe size		Dimension				Weight (kg)	Pipe Flange					
	NPS	DN	L	D1	D2	D		D3	Bolt No.	Stud Dia (d)		Stud Length (L1)	
										in	mm	RF	RJ
Class900 PN15.0/ ASME B16.5	2	50	70	140	58	51	8	165	8	7/8	M24	225	230
	2 1/2	65	83	162	73	65	11	190.5	8	1	M27	250	255
	3	80	83	165	90	80	14	190.5	8	7/8	M24	240	245
	4	100	102	204	108	102	20	235	8	1 1/8	M30	285	290
	5	125	110	245	136	127	30	279.5	8	1 1/4	M33	310	315
	6	150	159	286	162	150	42	317.5	12	1 1/8	M30	365	370
	8	200	206	356	212	200	84	393.5	12	1 3/8	M36×3	440	445
	10	250	241	432	266	250	145	470	16	1 3/8	M36×3	490	495
	12	300	292	495	312	305	220	533.5	20	1 3/8	M36×3	560	565
	14	350	356	518	355	337	350	559	20	1 1/2	M39×3	645	655
	16	400	384	572	400	387	470	616	20	1 5/8	M42×3	685	695
	18	450	451	635	450	438	605	686	20	1 7/8	M48×3	790	805
20	500	451	695	496	487	820	749.5	20	2	M52×3	810	825	
24	600	495	835	600	591	1050	901.5	20	2 1/2	M64×3	945	965	
Class1500 PN26.0/ ASME B16.5	2	50	70	140	58	51	8	165	8	7/8	M24	225	230
	2 1/2	65	83	162	73	65	11	190.5	8	1	M27	250	255
	3	80	83	172	90	80	19	203	8	1 1/8	M30	270	275
	4	100	102	207	108	102	26	241.5	8	1 1/4	M33	310	315
	5	125	110	252	136	127	51	292	8	1 1/2	M39	370	375
	6	150	159	280	162	150	68	317.5	12	1 3/8	M36	430	440
	8	200	206	350	212	200	130	393.5	12	1 5/8	M42	510	520
	10	250	248	433	266	254	210	482.5	12	1 7/8	M48	600	610
	12	300	305	518	312	305	384	517.5	16	2	M52	695	715
	14	350	356	576	355	337	550	635	16	2 1/4	M56	775	800
16	400	384	639	400	387	635	705	16	2 1/2	M64	850	880	
Class2500 PN42.0/ ASME B16.5	2	50	70	143	48	42	10	171.4	8	1	M27	260	260
	2 1/2	65	83	166	58	52	18	196.8	8	1 1/8	M30	290	300
	3	80	86	194	68	62	26	228.6	8	1 1/4	M33	315	325
	4	100	105	232	94	88	40	273	8	1 1/2	M39×3	370	375
	5	125	110	277	106	100	59	323.8	8	1 3/4	M45×3	420	430
	6	150	159	315	162	150	90	368.3	8	2	M52×3	515	525
	8	200	206	385	186	180	150	438.2	12	2	M52×3	600	615
	10	250	254	474	232	225	240	593.8	12	2 1/2	M64×3	760	780
	12	300	305	547	272	266	440	619.1	12	2 3/4	M70×3	860	880

DOUBLE-DISC WAFER TYPE CHECK VALVE

JIS SERIES 10K~20K

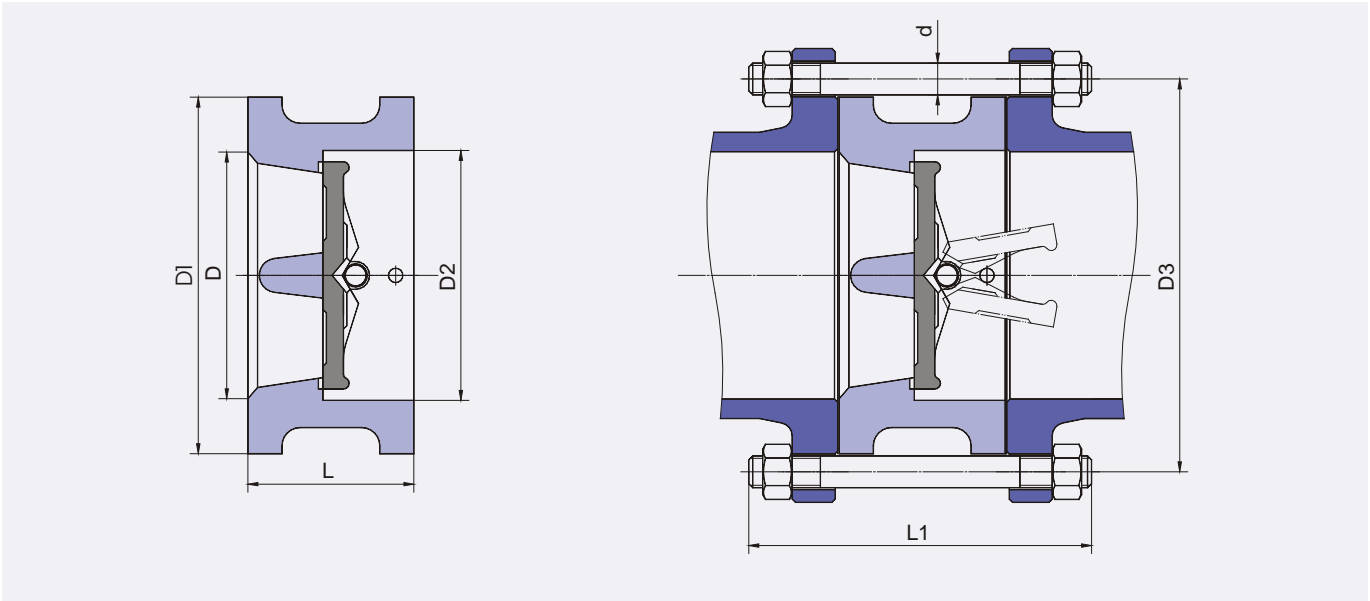

Main Dimensions & Weight

Pressure Class	Nominal pipe size DN	Dimension				Weight (kg)	Pipe Flange			
		L	D1	D2	D		D3	Bolt No.	Stud Dia (d)	Stud Length (L1) RF
JIS10K	50	60	103	56	51	2	120	4	M16	145
	65	67	121	73	65	3	140	4	M16	155
	80	73	131	88	80	4	150	8	M16	160
	100	73	156	108	102	6	175	8	M16	160
	125	86	187	132	127	8	210	8	M20	185
	150	98	217	160	152	12	240	8	M20	200
	200	127	267	210	203	25	290	12	M20	230
	250	146	330	266	254	35	355	12	M22	260
	300	181	375	310	305	50	400	16	M22	290
	350	184	420	355	350	80	445	16	M22	300
	400	191	483	405	400	110	510	16	M24	315
	450	203	538	455	450	130	565	20	M24	330
	500	219	593	505	500	160	620	20	M24	345
	600	222	697	605	600	330	730	24	M30	365
	700	305	807	700	695	380	840	24	M30	450
	800	305	917	800	796	560	950	28	M30	455
	900	368	1017	903	898	640	1050	28	M30	520
JIS20K	1000	432	1121	1055	1050	870	1160	28	M36	600
	1200	524	1341	1205	1200	1400	1380	32	M36	700
	1350	590	1495	1315	1312	2240	1540	36	M42	790
	1500	660	1655	1470	1458	2850	1700	40	M42	865
	50	60	101	58	51	3	120	8	M16	145
	65	67	121	73	65	4	140	8	M16	160
	80	73	137	88	80	6	160	8	M20	175
	100	73	162	108	102	8	185	8	M20	180
	125	86	200	132	127	15	225	8	M22	200
	150	98	235	160	152	18	260	12	M22	215
	200	127	280	210	203	30	305	12	M22	250
	250	146	353	266	254	50	380	12	M24	280
	300	181	403	310	305	70	430	16	M24	320
	350	222	447	355	350	110	480	16	M30×3	380
	400	232	507	405	400	180	540	16	M30×3	400
	450	264	572	455	450	200	605	20	M30×3	435
	500	292	627	505	500	260	660	20	M30×3	470
600	318	731	608	600	410	770	24	M36×3	515	
700	381	852	693	684	580	900	24	M45×3	620	
800	406	974	790	779	970	1030	24	M52×3	675	
900	483	1084	885	874	1020	1140	28	M52×3	760	

DOUBLE-DISC WAFER TYPE CHECK VALVE

GB SERIES PN1.0~PN1.6

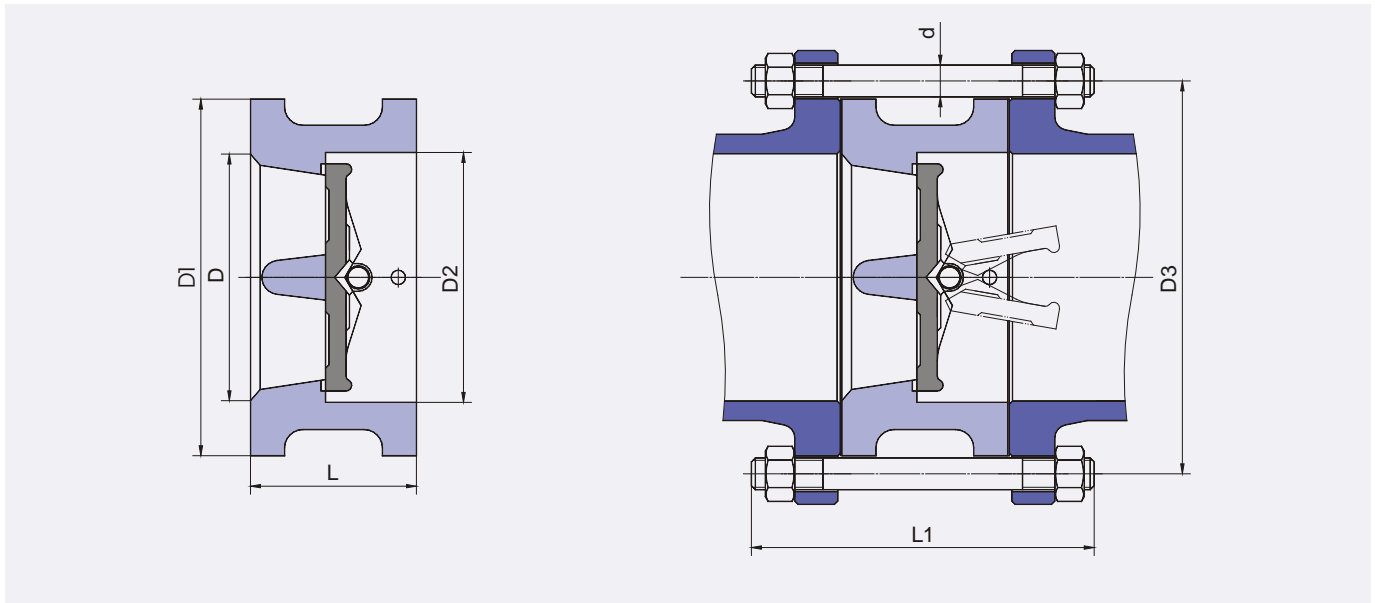

Main Dimensions & Weight

Pressure Class	Nominal pipe size		Dimension				Weight (kg)	Pipe Flange				
	DN	NPS	L	D1	D2	D		D3	Bolt No.	Stud Dia (d)		
										mm	RF	RJ
PN1.0	50	2	60	108	56	51	2	125	4	M16	150	—
	65	2 1/2	67	128	73	65	3	145	4	M16	160	—
	80	3	73	142	88	80	4	160	8	M16	165	—
	100	4	73	162	108	102	6	180	8	M16	170	—
	125	5	86	192	132	127	8	210	8	M16	180	—
	150	6	98	218	160	152	13	240	8	M20	200	—
	200	8	127	273	210	203	24	295	8	M20	225	—
	250	10	146	328	266	254	37	350	12	M20	250	—
	300	12	181	378	310	305	50	400	12	M20	285	—
	350	14	184	438	355	350	76	460	16	M20	290	—
	400	16	191	489	405	400	110	515	16	M24	305	—
	450	18	203	539	455	450	135	565	20	M24	320	—
	500	20	219	594	505	500	158	620	20	M24	335	—
	600	24	222	696	605	600	320	725	20	M27	355	—
	700	28	305	811	700	695	380	840	24	M27	440	—
800	32	305	918	800	796	560	950	24	M30	450	—	
900	36	368	1018	903	898	640	1050	28	M30	515	—	
1000	40	432	1124	1055	1050	900	1160	28	M33	590	—	
1200	48	524	1340	1205	1200	1400	1380	32	M36	700	—	
PN1.6	50	2	60	108	56	51	2	125	4	M16	150	—
	65	2 1/2	67	128	73	65	3	145	4	M16	160	—
	80	3	73	142	88	80	4	160	8	M16	165	—
	100	4	73	162	108	102	6	180	8	M16	170	—
	125	5	86	192	132	127	8	210	8	M16	180	—
	150	6	98	218	160	152	13	240	8	M20	200	—
	200	8	127	273	210	203	24	295	12	M20	225	—
	250	10	146	329	266	254	37	355	12	M24	255	—
	300	12	181	384	310	305	50	410	12	M24	290	—
	350	14	184	444	355	350	76	470	16	M24	295	—
	400	16	191	496	405	400	110	525	16	M27	305	—
	450	18	203	556	455	450	135	585	20	M27	320	—
	500	20	219	618	505	500	158	650	20	M30	345	—
	600	24	222	732	605	600	320	770	20	M33	360	—
	700	28	305	802	700	695	380	840	24	M33	445	—
800	32	305	912	800	796	560	950	24	M36	455	—	
900	36	368	1012	903	898	640	1050	28	M36	520	—	
1000	40	432	1126	1055	1050	900	1170	28	M39	600	—	
1200	48	524	1340	1205	1200	1400	1390	32	M45	710	—	

DOUBLE-DISC WAFER TYPE CHECK VALVE

GB SERIES PN2.5-PN10.0

Main Dimensions & Weight

To be Continued

Pressure Class	Nominal pipe size		Dimension				Weight (kg)	Pipe Flange					
	DN	NPS	L	D1	D2	D		D3	Bolt No.	Stud Dia (d)		Stud Length (L1)	
										mm	RF	RJ	
PN2.5	50	2	60	108	56	51	2	125	4	M16	150	—	
	65	2 1/2	67	128	73	65	3	145	8	M16	160	—	
	80	3	73	142	88	80	4	160	8	M16	165	—	
	100	4	73	168	108	102	6	190	8	M20	170	—	
	125	5	86	194	132	127	8	220	8	M24	180	—	
	150	6	98	224	160	152	14	250	8	M24	200	—	
	200	8	127	284	210	203	27	310	12	M24	250	—	
	250	10	146	341	266	254	42	370	12	M27	280	—	
	300	12	181	401	310	305	54	430	16	M27	320	—	
	350	14	184	458	355	350	86	490	16	M30	340	—	
	400	16	191	515	405	400	120	550	16	M33	350	—	
	450	18	203	565	455	450	148	600	20	M33	380	—	
	500	20	219	622	505	500	165	660	20	M33	400	—	
	600	24	222	732	605	600	340	770	20	M36	430	—	
	700	28	305	831	700	695	400	875	24	M39	495	—	
800	32	305	942	800	796	580	990	24	M45	510	—		
900	36	368	1040	903	898	660	1090	28	M45	590	—		
1000	40	432	1155	1055	1050	960	1210	28	M52	680	—		
1200	48	524	1365	1205	1200	1440	1420	32	M52	780	—		
PN4.0	50	2	60	108	58	51	3	125	4	M16	150	—	
	65	2 1/2	67	128	73	65	4	145	8	M16	160	—	
	80	3	73	142	88	80	6	160	8	M16	165	—	
	100	4	73	168	108	102	8	190	8	M20	175	—	
	125	5	86	194	132	127	13	220	8	M24	200	—	
	150	6	98	224	160	152	16	250	8	M24	215	—	
	200	8	127	291	210	203	28	320	12	M27	265	—	
	250	10	146	353	266	254	49	385	12	M30	295	—	
	300	12	181	418	310	305	76	450	16	M30	335	—	
	350	14	222	475	355	350	114	510	16	M33	395	—	
	400	16	232	547	405	400	190	585	16	M36	420	—	
	450	18	264	572	455	450	200	610	20	M36	470	—	
500	20	292	626	505	500	260	670	20	M39	500	—		
600	24	318	745	608	600	404	795	20	M45	575	—		
PN6.3	50	2	60	114	58	51	4	135	4	M20	170	—	
	65	2 1/2	67	138	73	65	5	160	8	M20	175	—	
	80	3	73	148	88	80	7	170	8	M20	185	—	
	100	4	79	174	108	102	10	200	8	M24	195	—	
	125	5	105	211	132	127	16	240	8	M27	245	—	
	150	6	136	248	160	152	20	280	8	M30	285	—	
	200	8	165	310	210	200	38	345	12	M33	330	—	
	250	10	213	362	266	250	62	400	12	M33	390	—	
	300	12	229	422	310	305	100	460	16	M33	415	—	
350	14	273	487	355	350	160	525	16	M36	475	—		
400	16	305	541	405	400	260	585	16	M39	520	—		
PN10.0	50	2	60	120	58	51	5	145	4	M24	180	—	
	65	2 1/2	67	144	73	65	7	170	8	M24	195	—	
	80	3	73	154	88	80	10	180	8	M24	205	—	
	100	4	79	181	108	102	12	210	8	M27	220	—	
	125	5	105	218	132	127	19	250	8	M30	265	—	
	150	6	136	258	160	152	25	290	12	M30	305	—	
	200	8	165	324	210	200	56	360	12	M33	355	—	
	250	10	213	392	266	250	94	430	12	M36	425	—	
	300	12	229	456	310	305	142	500	16	M39	460	—	
350	14	273	510	355	350	230	560	16	M45	530	—		
400	16	305	570	405	400	366	620	16	M45	580	—		

DOUBLE-DISC WAFER TYPE CHECK VALVE

GB SERIES PN16.0~PN25.0

Main Dimensions & Weight

To be Continued

Pressure Class	Nominal pipe size		Dimension				Weight (kg)	Pipe Flange					
	DN	NPS	L	D1	D2	D		D3	Bolt No.	Stud Dia (d)		Stud Length (L1)	
										mm	RF	RJ	
PN16.0 (JB Flange)	50	2	70	142	56	51	8	165	8	M22	205	—	
	65	2 1/2	83	162	73	65	11	190	8	M27	245	—	
	80	3	83	176	90	80	16	205	8	M27	245	—	
	100	4	102	208	108	102	19	240	8	M30	275	—	
	125	5	110	247	136	127	33	285	8	M36	320	—	
	150	6	159	280	162	150	40	318	12	M36	380	—	
	200	8	206	356	212	203	84	400	12	M42	465	—	
	250	10	241	435	266	250	146	485	12	M48	540	—	
PN16.0	50	2	70	120	56	51	7	145	4	M24	210	—	
	65	2 1/2	83	144	73	65	10	170	8	M24	235	—	
	80	3	83	154	90	80	14	180	8	M24	240	—	
	100	4	102	181	108	102	17	210	8	M27	280	—	
	125	5	110	218	136	127	28	250	8	M30	300	—	
	150	6	159	258	162	152	36	290	12	M30	360	—	
	200	8	206	325	212	203	78	360	12	M33	425	—	
	250	10	241	389	266	254	130	430	12	M39	490	—	
PN20.0 (JB Flange)	50	2	70	136	56	51	8	160	8	M22	210	—	
	65	2 1/2	83	174	73	65	16	203	8	M27	250	—	
	80	3	83	198	90	80	22	230	8	M30	270	—	
	100	4	102	254	108	102	35	292	8	M36	325	—	
	125	5	110	280	136	127	50	318	12	M36	350	—	
	150	6	159	316	162	152	78	360	12	M42	425	—	
	200	8	206	390	212	203	120	440	12	M48	510	—	
	250	10	248	518	266	254	220	572	16	M52	590	—	
PN25.0 (BS4504)	50	2	70	124	56	51	8	150	8	M24	210	—	
	65	2 1/2	83	154	73	65	14	180	8	M24	235	—	
	80	3	83	171	90	80	20	200	8	M27	250	—	
	100	4	102	203	108	102	28	235	8	M30	290	—	
	125	5	110	243	136	127	44	275	12	M30	310	—	
	150	6	159	285	162	152	70	320	12	M33	380	—	
	200	8	206	359	212	203	110	400	12	M39	470	—	
	250	10	248	443	266	254	200	490	16	M45	560	—	
300	12	305	540	312	305	350	590	16	M48	660	—		