

KOFLow

CHECK VALVE SERIES

43-71P

FIGURE NUMBER SYSTEM

Check Valve Figure Number System

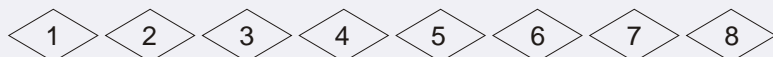

1	Size	Xxin; xx, mm						
2	Operation type	Not suitable						
3	Valve Type	H-Check Valve						
4	Pressure	0-PN10	1-PN16 class150	2-PN25	3-class300	4-PN40 class400	6-PN64 class600	
		9-class900	10-PN100	15-class1500	16-PN160	20-PN200	25-class2500	
5	Connection Ends	RF-Raised Face	FF Flat Face	MFM Male and Female Face		TG Tongue and Groove face		
		RJ Ring Joint		BW Butt weld		WF-Wafer Type		
6	Structure Type	1-Lift Type		4-Single Disc Swing type		6-Double Disc Swing type		7-Tilting Disc Type
7	Basic Material	C-WCB	C-C5	C6-WC6	C9-WC9	BL-LCB		CL-LCC
		8-CF8	8M-CF8M	3-CF3	3M-CF3M	ML-MONEL		
8	Material of Seat face or Liner	H-Cr13 S.S		E-18-8 S.S		R-Mo2Ti S.S		
		D- nitriding steel		M- Monel Alloy		Y-Stellited		

Note:

- 1、 Use "W" to express seat sealing surface material which is processed directly by valve body.
- 2、 When the materials of sealing surface are different, use low hardness material symbol to express
- 3、 Special Requirements not shown ,should be indicated in the purchase order
- 4、 The models listed in the sample book have no reference to pressure、 sizes and valve material symbols, they are to be decided by users.

For example

8 " -H1RF4CH

Check valve, 8 " ANSI CLASS150, Raised Face Ends, Single Disc Swing type, Body&Bonnet&Disc Cast Steel WCB, Seat sealing face material 13Cr

50-H2WF68W

Check valve, DN80 PN25, Wafer type, Double Disc Swing type, Body&Bonnet&Disc Stainless Steel CF8, Seat sealing face Body machined.

WAFER TYPE LIFT CHECK VALVE

Design of Wafer type lift Check Valve

Wafer Type Lift Check Valve Product Line

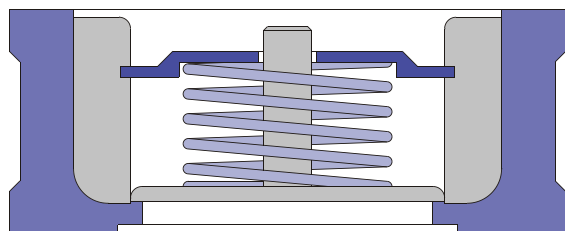

DN ≤ 100

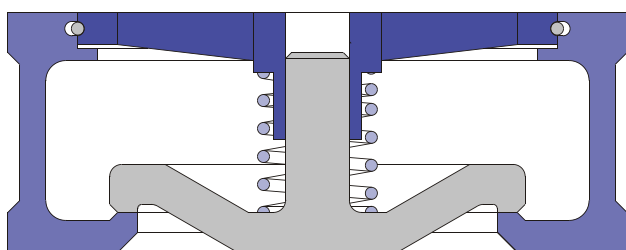

DN ≥ 125

Size		Pressure (CLASS)										
		API Series (CLASS)				GB Series (PN)						
DN	NPS	150	300	600	900	1.0	1.6	2.5	4.0	6.4	10.0	16.0
15	1/2	*	*	*	*	*	*	*	*	*	*	*
20	3/4	*	*	*	*	*	*	*	*	*	*	*
25	1	*	*	*	*	*	*	*	*	*	*	*
32	1-1/4	*	*	*	*	*	*	*	*	*	*	*
40	1-1/2	*	*	*	*	*	*	*	*	*	*	*
50	2	*	*	*	*	*	*	*	*	*	*	*
65	2-1/2	*	*	*	*	*	*	*	*	*	*	*
80	3	*	*	*	*	*	*	*	*	*	*	*
100	4	*	*	*	*	*	*	*	*	*	*	*
125	5	*	*	*	*	*	*	*	*	*	*	*
150	6	*	*	*	*	*	*	*	*	*	*	*
200	8	*	*	*	*	*	*	*	*	*	*	*

For sizes and classes not shown, please contact our Sales Department

Material List of Lift Type Check Valve

No.	Part Name	ASTM			GB		
		Carbon Steel	Stainless Steel	Alloy Steel	Carbon Steel	Stainless Steel	Alloy Steel
1	Body	A216 WCB	A351 CF8	A217 WC6	WCB	CF8	WC6
2	Disc	A351 CF8	A351 CF8	A351 CF8	CF8	CF8	CF8
3	Spring	A182 F304	A182 F304	A182 F304	0Cr18Ni9(304)	0Cr18Ni9(304)	0Cr18Ni9(304)
4	Plate	A182 F6a	A182 F304	A182 F304	WCB	CF8	WC6
5	Locking	A182 F304	A182 F304	A182 F304	0Cr18Ni9(304)	0Cr18Ni9(304)	0Cr18Ni9(304)

Remark: 1、 Select different materials for different working temperature and media

Technical Specification

Design Standard		API6D、API594				GB/T 12221						
Pressure-Temperature Rating		ASME B16.34				GB/T 12224						
Face-Face		API6D、API594				Factory Standard						
Flange Ends		ASME B16.5、ASME B16.47				GB/T9113、JB/T79						
Inspection & Test		API598、API6D				JB/T9092、GB/T13927						
Test Pressure	Norminal Pressure	CL150	CL300	CL600	CL900	PN1.0	PN1.6	PN2.5	PN4.0	PN6.4	PN10.0	PN16.0
	Shell Test	2.93	7.55	10.0	15.0	2.0	2.4	3.75	6.0	9.6	15.0	24.0
	High Pressure Seal Test	2.07	5.52	7.31	11.03	1.1	1.76	2.75	4.4	7.04	11.0	17.6
	Low Pressure Seal Test	0.6										

WAFER TYPE LIFT CHECK VALVE

API Pressure:CLASS150~900

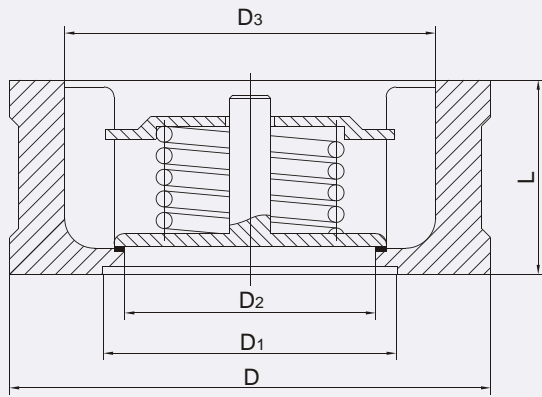

Fig.HWF1

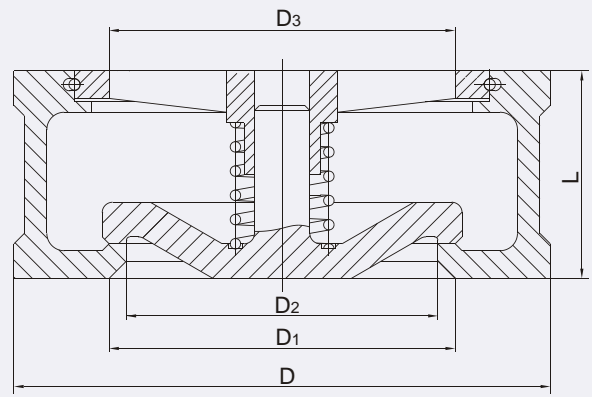

Fig.HWF1

Main Dimensions & Weight

Pressure	Size		Valve Main Dimension					Weight (kg)
	mm	in.	L	D	D ₁	D ₂	D ₃	
CLASS150	15	1/2	25	46	25	15	25	0.28
	20	3/4	31.5	56	30	19	30	0.42
	25	1	35.5	65	36	24	36	0.56
	32	1-1/4	40	74	43	31	43	0.75
	40	1-1/2	45	84	52	39	52	1.3
	50	2	56	103	62	48	62	2.1
	65	2-1/2	63	122	75	62	75	2.8
	80	3	71	135	90	76	90	3.6
	100	4	80	173	112	95	112	4.8
	125	5	110	195	125	110	132	12
	150	6	125	220	150	127	158	17
CLASS300	200	8	160	277	200	165	208	29
	15	1/2	25	52	25	15	25	0.3
	20	3/4	31.5	65	30	19	30	0.46
	25	1	35.5	72	36	24	36	0.6
	32	1-1/4	40	81	43	31	43	0.8
	40	1-1/2	45	94	52	39	52	1.5
	50	2	56	110	62	48	62	2.4
	65	2-1/2	63	128	75	62	75	3.0
	80	3	71	147	90	76	90	4.0
	100	4	80	179	112	95	112	5.5
	125	5	110	214	125	110	132	13
CLASS600	150	6	125	249	150	127	158	22
	200	8	160	305	200	165	208	36
	15	1/2	25	52	25	15	25	0.4
	20	3/4	31.5	65	30	19	30	0.8
	25	1	35.5	72	36	24	36	1.0
	32	1-1/4	40	81	43	31	43	1.3
	40	1-1/2	45	94	52	39	52	1.8
	50	2	56	110	62	48	62	2.8
	65	2-1/2	63	128	75	62	75	4
	80	3	71	147	90	76	90	6
	100	4	80	191	112	95	112	11
CLASS900	125	5	110	239	125	110	132	25
	150	6	125	264	150	127	158	32
	200	8	160	318	200	165	208	52
	15	1/2	25	62	25	15	25	0.6
	20	3/4	31.5	69	30	19	30	0.9
	25	1	35.5	77	36	24	36	1.2
	32	1-1/4	40	87	43	31	43	1.5
	40	1-1/2	45	97	52	39	52	2.0
	50	2	56	140	62	48	62	5.5
	65	2-1/2	63	162	75	62	75	7.5
	80	3	71	165	90	76	90	8
100	4	80	204	112	95	112	14	
125	5	110	245	125	110	132	27	
150	6	125	286	150	127	158	41	
200	8	160	356	200	165	208	76	

WAFER TYPE LIFT CHECK VALVE

GB Pressure:PN1.0~4.0

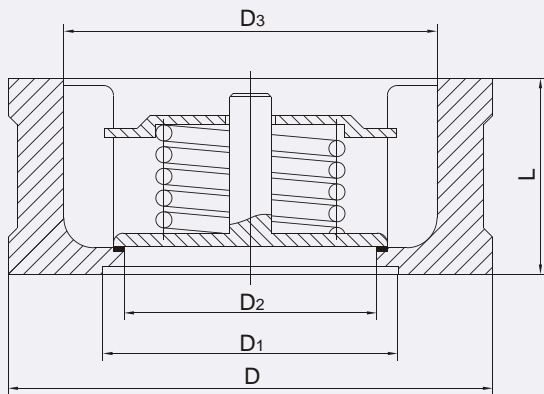

Fig.HWF1

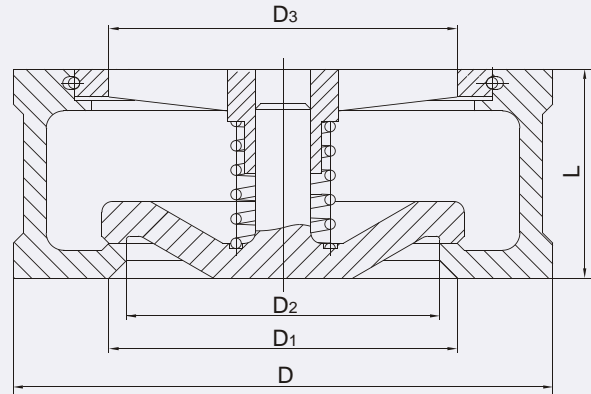

Fig.HWF1

Main Dimensions & Weight

Pressure	Size		Valve Main Dimension					Weight (kg)
	mm	in.	L	D	D ₁	D ₂	D ₃	
PN1.0	15	1/2	16	52	24	15	31	0.12
	20	3/4	19	62	30	19	40	0.24
	25	1	22	72	36	24	47	0.34
	32	1-1/4	28	83	46	31	56	0.53
	40	1-1/2	31.5	93	55	39	66	0.80
	50	2	40	108	65	48	78	1.2
	65	2-1/2	46	128	80	62	95	1.8
	80	3	50	142	96	76	110	2.2
	100	4	60	162	115	95	135	3.4
	125	5	90	192	125	110	132	9.0
PN1.6	15	1/2	16	52	24	15	31	0.12
	20	3/4	19	62	30	19	40	0.24
	25	1	22	72	36	24	47	0.34
	32	1-1/4	28	83	46	31	56	0.53
	40	1-1/2	31.5	93	55	39	66	0.80
	50	2	40	108	65	48	78	1.2
	65	2-1/2	46	128	80	62	95	1.8
	80	3	50	142	96	76	110	2.2
	100	4	60	162	115	95	135	3.4
	125	5	90	192	125	110	132	9.0
PN2.5	15	1/2	16	52	24	15	31	0.12
	20	3/4	19	62	30	19	40	0.24
	25	1	22	70	36	24	47	0.34
	32	1-1/4	28	83	46	31	56	0.53
	40	1-1/2	31.5	93	55	39	66	0.80
	50	2	40	108	65	48	78	1.2
	65	2-1/2	46	128	80	62	95	1.8
	80	3	50	142	96	76	110	2.2
	100	4	60	168	115	95	135	3.8
	125	5	90	194	125	110	132	9.2
PN4.0	15	1/2	16	52	24	15	31	0.12
	20	3/4	19	62	30	19	40	0.24
	25	1	22	70	36	24	47	0.34
	32	1-1/4	28	83	46	31	56	0.53
	40	1-1/2	31.5	93	55	39	66	0.80
	50	2	40	108	65	48	78	1.2
	65	2-1/2	46	128	80	62	95	1.8
	80	3	50	142	96	76	110	2.2
	100	4	60	168	115	95	135	3.8
	125	5	90	194	125	110	132	9.2
150	6	106	224	150	127	158	15	
200	8	140	284	200	165	208	26	

WAFER TYPE LIFT CHECK VALVE

GB Pressure:PN1.0~4.0

Main Dimensions & Weight

To be Continued

Pressure	Size		Valve Main Dimension					Weight (kg)
	mm	in.	L	D	D ₁	D ₂	D ₃	
PN1.0 (Long Series)	15	1/2	25	52	25	15	25	0.3
	20	3/4	31.5	62	30	19	30	0.45
	25	1	35.5	72	36	24	36	0.6
	32	1-1/4	40	83	43	31	43	0.8
	40	1-1/2	45	93	52	39	52	1.4
	50	2	56	108	62	48	62	2.3
	65	2-1/2	63	128	75	62	75	3.0
	80	3	71	142	90	76	90	3.8
	100	4	80	162	112	95	112	5.0
	125	5	110	192	125	110	132	11
	150	6	125	218	150	127	158	16
PN1.6 (Long Series)	15	1/2	25	52	25	15	25	0.3
	20	3/4	31.5	62	30	19	30	0.45
	25	1	35.5	72	36	24	36	0.6
	32	1-1/4	40	83	43	31	43	0.8
	40	1-1/2	45	93	52	39	52	1.4
	50	2	56	108	62	48	62	2.3
	65	2-1/2	63	128	75	62	75	3.0
	80	3	71	142	90	76	90	3.8
	100	4	80	162	112	95	112	5.0
	125	5	110	192	125	110	132	11
	150	6	125	218	150	127	158	16
PN2.5 (Long Series)	15	1/2	25	52	25	15	25	0.3
	20	3/4	31.5	62	30	19	30	0.45
	25	1	35.5	72	36	24	36	0.6
	32	1-1/4	40	83	43	31	43	0.8
	40	1-1/2	45	93	52	39	52	1.4
	50	2	56	108	62	48	62	2.3
	65	2-1/2	63	128	75	62	75	3.0
	80	3	71	142	90	76	90	3.8
	100	4	80	168	112	95	112	5.3
	125	5	110	194	125	110	132	12
	150	6	125	224	150	127	158	18
PN4.0 (Long Series)	15	1/2	25	52	25	15	25	0.3
	20	3/4	31.5	62	30	19	30	0.45
	25	1	35.5	72	36	24	36	0.6
	32	1-1/4	40	83	43	31	43	0.8
	40	1-1/2	45	93	52	39	52	1.4
	50	2	56	108	62	48	62	2.3
	65	2-1/2	63	128	75	62	75	3.0
	80	3	71	142	90	76	90	3.8
	100	4	80	168	112	95	112	5.3
	125	5	110	194	125	110	132	13
	150	6	125	224	150	127	158	19
200	8	160	291	200	165	208	32	

WAFER TYPE LIFT CHECK VALVE

GB Pressure:PN6.4~16.0

Main Dimensions & Weight

To be Continued

Pressure	Size		Valve Main Dimension					Weight (kg)
	mm	in.	L	D	D ₁	D ₂	D ₃	
PN6.4	15	1/2	25	62	25	15	25	0.5
	20	3/4	31.5	73	30	19	30	0.7
	25	1	35.5	83	36	24	36	1.0
	32	1-1/4	40	89	43	31	43	1.3
	40	1-1/2	45	104	52	39	52	2.0
	50	2	56	114	62	48	62	3.2
	65	2-1/2	63	138	75	62	75	4.5
	80	3	71	148	90	76	90	5
	100	4	80	174	112	95	112	7
	125	5	110	211	125	110	132	13
	150	6	125	248	150	127	158	22
	200	8	160	310	200	165	208	40
PN10.0	15	1/2	25	62	25	15	25	0.6
	20	3/4	31.5	73	30	19	30	1.0
	25	1	35.5	83	36	24	36	1.3
	32	1-1/4	40	89	43	31	43	1.6
	40	1-1/2	45	104	52	39	52	2.5
	50	2	56	120	62	48	62	3.8
	65	2-1/2	63	144	75	62	75	6
	80	3	71	154	90	76	90	7
	100	4	80	181	112	95	112	10
	125	5	110	218	125	110	132	18
	150	6	125	258	150	127	158	30
	200	8	160	324	200	165	208	56
PN16.0 (JB FLANGE)	15	1/2	25	58	25	15	25	0.6
	20	3/4	31.5	69	30	19	30	0.9
	25	1	35.5	79	36	24	36	1.3
	32	1-1/4	40	92	43	31	43	1.7
	40	1-1/2	45	100	52	39	52	2.2
	50	2	56	142	62	48	62	5.6
	65	2-1/2	63	162	75	62	75	7.5
	80	3	71	176	90	76	90	9
	100	4	80	208	112	95	112	14
	125	5	110	247	125	110	132	27
	150	6	125	280	150	127	158	38
	200	8	160	356	200	165	208	76
PN16.0 (GB , HG FLANGE)	15	1/2	25	62	25	15	25	0.6
	20	3/4	31.5	73	30	19	30	1.0
	25	1	35.5	83	36	24	36	1.3
	32	1-1/4	40	89	43	31	43	1.6
	40	1-1/2	45	104	52	39	52	2.5
	50	2	56	120	62	48	62	3.8
	65	2-1/2	63	144	75	62	75	6
	80	3	71	154	90	76	90	7
	100	4	80	181	112	95	112	10
	125	5	110	218	125	110	132	18
	150	6	125	258	150	127	158	30
	200	8	160	325	200	165	208	58