

KOFLow

CHECK VALVE SERIES

43-71P

FIGURE NUMBER SYSTEM

Check Valve Figure Number System

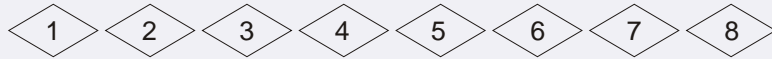

1	Size	Xxin; xx, mm						
2	Operation type	Not suitable						
3	Valve Type	H-Check Valve						
4	Pressure	0-PN10	1-PN16 class150	2-PN25	3-class300	4-PN40 class400	6-PN64 class600	
		9-class900	10-PN100	15-class1500	16-PN160	20-PN200	25-class2500	
5	Connection Ends	RF-Raised Face	FF Flat Face	MFM Male and Female Face		TG Tongue and Groove face		
		RJ Ring Joint		BW Butt weld		WF-Wafer Type		
6	Structure Type	1-Lift Type		4-Single Disc Swing type		6-Double Disc Swing type		7-Tilting Disc Type
7	Basic Material	C-WCB	C-C5	C6-WC6	C9-WC9	BL-LCB		CL-LCC
		8-CF8	8M-CF8M	3-CF3	3M-CF3M	ML-MONEL		
8	Material of Seat face or Liner	H-Cr13 S.S			E-18-8 S.S		R-Mo2Ti S.S	
		D- nitriding steel			M- Monel Alloy		Y-Stellited	

Note:

- 1、 Use "W" to express seat sealing surface material which is processed directly by valve body.
- 2、 When the materials of sealing surface are different, use low hardness material symbol to express
- 3、 Special Requirements not shown ,should be indicated in the purchase order
- 4、 The models listed in the sample book have no reference to pressure、 sizes and valve material symbols, they are to be decided by users.

For example

8 " -H1RF4CH

Check valve, 8 " ANSI CLASS150, Raised Face Ends, Single Disc Swing type, Body&Bonnet&Disc Cast Steel WCB, Seat sealing face material 13Cr

50-H2WF68W

Check valve, DN80 PN25, Wafer type, Double Disc Swing type, Body&Bonnet&Disc Stainless Steel CF8, Seat sealing face Body machined.

TILTING DISC CHECK VALVE

Design of Tilting Disc Check Valve

Tilting Disc Check Valve Product Line

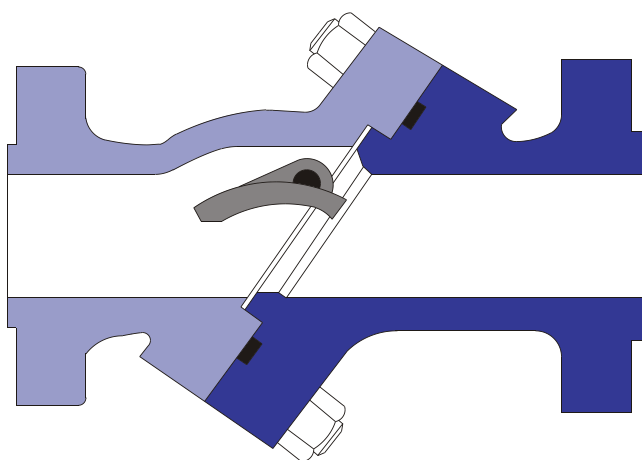

Type of end connection referred to Appendix I

Size		Pressure (class)				
DN	NPS	150	300	600	900	1500
50	2	*	*	*	*	*
65	2-1/2	*	*	*	*	*
80	3	*	*	*	*	*
100	4	*	*	*	*	*
125	5	*	*	*	*	*
150	6	*	*	*	*	*
200	8	*	*	*	*	*
250	10	*	*	*	*	*
300	12	*	*	*	*	*
350	14	*	*	*	*	*
400	16	*	*	*	*	*
450	18	*	*	*	*	*
500	20	*	*	*	*	*
600	24	*	*	*	*	*
650	26	*	*	*	*	*
700	28	*	*	*	*	*
750	30	*	*	*	*	*
900	36	*	*	*	*	*

For sizes and classes not shown, please contact our Sales Department

Material List of Tilting Disc Check Valve(ASTM Standard Material)

No.	Part Name	ASTM		
		Carbon Steel	Stainless Steel	Alloy Steel
1	Body	A216 WCB	A351 CF8	A217 WC6
2	Body	A216 WCB	A351 CF8	A217 WC6
3	Disc	A351 CF8	A351 CF8	A351 CF8
4	Pin	A182 F6a	A182 F304	A182 F304
5	Stud	A193 B7	A193 B8	A193 B7
6	Nut	A194 2H	A194 8	A194 4
7	Gasket	Graphite+304		
8	Bearing Cap	A105	A182 F304	A182 F304
9	Gasket	Carbon Steel	Stainless Steel	Stainless Steel
10	Stud	A193 B7	A193 B8	A193 B7
11	Nut	A194 2H	A194 8	A194 4
12	Connection Pin	ANSI1020	A182 F304	A182 F304

Remark: 1、 Select different materials for different working temperature and media

Technical Specification

Design Standard	API6D、 API594					
Pressure-Temperature Rating	ASME B16.34					
Face-Face	API6D、 API594					
Flange Ends	ASME B16.5 、 ASME B16.47					
Inspection & Test	API598、 API6D					
Test Pressure	Normal Pressure(CLASS)	150	300	600	900	1500
	Shell Test	2.93	7.55	10.0	15.0	37.5
	High Pressure Seal Test	2.07	5.52	7.31	11.03	27.5
	Low Pressure Seal Test	0.6				

TILTING DISC CHECK VALVE

Pressure:CLASS150 ~ 300

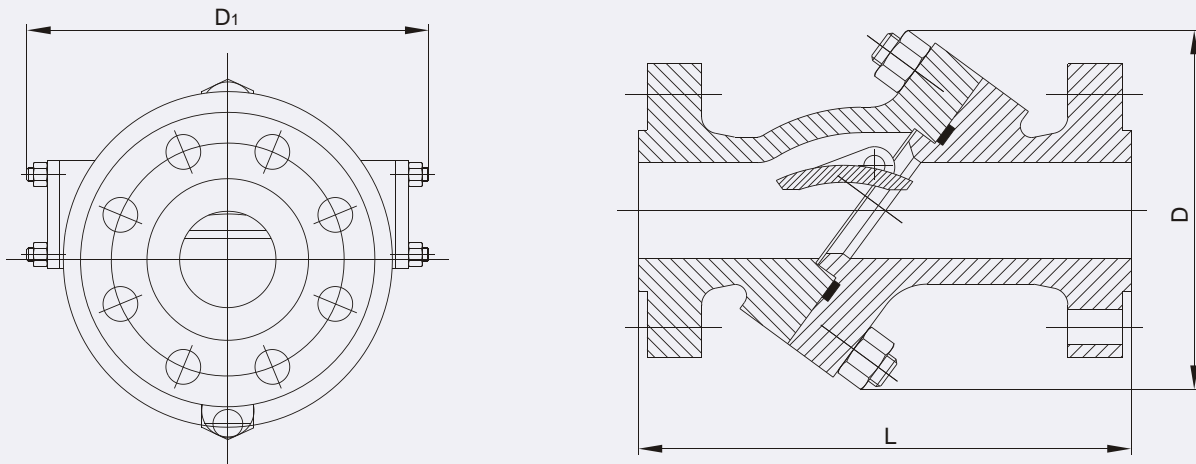

Fig.HRF7

Main Dimensions & Weight

Pressure	Size		Valve Main Dimension				Weight (kg)	
	mm	in.	LRF	LBW	D	D1	WRF	WBW
CLASS150	50	2	203	203	186	-	17	10
	65	2-1/2	216	216	217	-	23	17
	80	3	241	241	217	-	27	19
	100	4	292	292	251	337	46	34
	125	5	330	330	286	397	63	49
	150	6	356	356	-	-	-	-
	200	8	495	495	403	527	133	109
	250	10	622	622	476	635	221	181
	300	12	698	698	543	705	313	259
	350	14	787	787	570	724	373	313
	400	16	762	762	633	864	485	401
	450	18	838	838	705	908	651	550
	500	20	826	826	778	988	828	798
	600	24	965	965	910	1133	1310	1027
	750	30	1257	1257	1105	1365	2173	1826
900	36	1511	1511	1270	1530	3082	2610	
CLASS300	50	2	267	267	205	-	26	17
	65	2-1/2	292	292	241	-	39	26
	80	3	318	318	241	-	41	27
	100	4	356	356	273	362	76	48
	125	5	400	400	317	416	98	75
	150	6	444	444	-	-	-	-
	200	8	622	622	432	559	207	153
	250	10	533	533	514	638	304	236
	300	12	711	711	610	756	467	379
	350	14	762	762	632	768	565	481
	400	16	838	838	706	914	769	576
	450	18	914	914	781	1003	989	764
	500	20	991	991	826	1035	1201	839
	600	24	1143	1143	953	1149	1846	1266
	750	30	1372	1372	1130	1365	2812	2110
900	36	1524	1524	1432	1727	5376	4536	

TILTING DISC CHECK VALVE

Pressure: CLASS600 ~ 1500

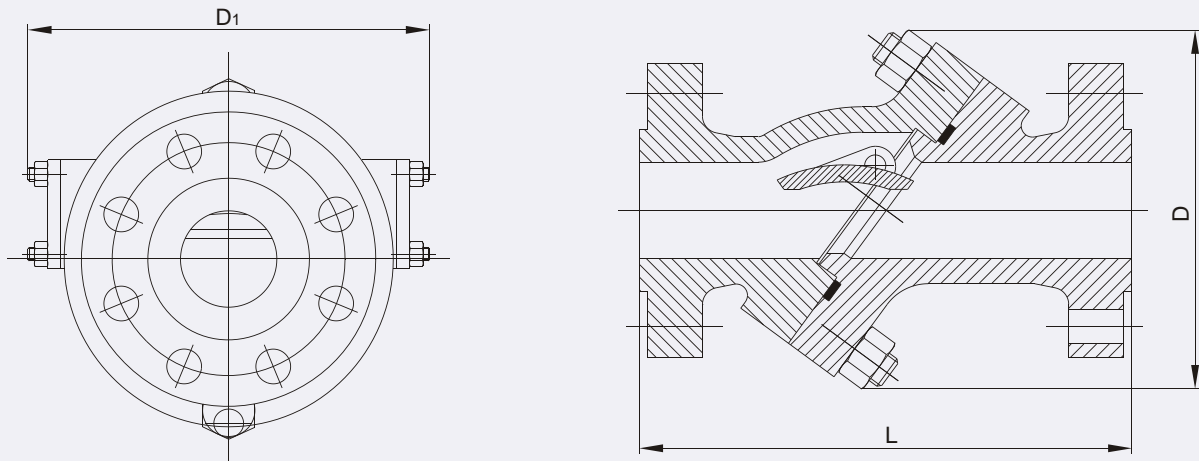

Fig.HRF7

Main Dimensions & Weight

Pressure	Size		Valve Main Dimension				Weight (kg)	
	mm	in.	LRF	LBW	D	D1	WRF	WBW
CLASS600	50	2	292	292	213	-	31	27
	65	2-1/2	330	330	254	-	50	32
	80	3	356	356	254	-	52	39
	100	4	432	432	327	406	101	74
	125	5	508	508	368	489	148	121
	150	6	559	559	406	514	196	134
	200	8	660	660	486	597	329	197
	250	10	787	787	562	699	469	372
	300	12	838	838	656	794	667	479
	350	14	889	889	695	841	830	606
	400	16	991	991	756	917	1157	891
	450	18	1092	1092	870	1085	1619	1310
	500	20	1194	1194	953	1165	2180	1830
	600	24	1397	1397	1111	1352	3061	2654
	750	30	1499	1499	1235	1524	3941	3499
CLASS900	80	3	381	381	279	406	80	49
	100	4	457	457	311	470	124	74
	150	6	610	610	365	565	199	130
	200	8	737	737	416	603	274	210
	250	10	838	838	508	718	476	345
	300	12	965	965	622	884	803	653
	350	14	1029	1029	700	879	1095	730
	400	16	1130	1130	784	1070	-	912
	450	18	1219	1219	927	1143	-	1025
CLASS1500	50	2	368	368	311	435	81	70
	65	2-1/2	419	419	311	435	100	75
	80	3	470	470	311	435	102	82
	100	4	546	546	375	540	195	122
	150	6	705	705	470	603	435	363
	200	8	832	832	565	768	771	553
	250	10	991	991	724	972	1066	850