

# Weatherproof type pressure switch

## Model: P940 series

Spec. sheet no. PD09-04

### Service intended

P940 series pressure switches are micro contact type, and these are suitable for corrosive fluids and high pressure measurements. Dead band is fixed.



### Nominal diameter

Refer to dimension drawing

### Repeatability

±1.0% of adjustable range

### Adjustable setting range (MPa, kPa, bar)

-0.1 ~ 0 to -0.1 ~ 2.5 MPa  
0 ~ 0.1 to 0 ~ 35 MPa

### Dead band

One SPDT : 5 ~ 6% of full scale  
Two SPDT : 10 ~ 12% of full scale

### Working temperature

Ambient : -20 ~ 65°C  
Fluid : Max. 100°C



## Standard features

### Pressure connection

Stainless steel (316SS)

### Element material

Stainless steel (316SS)

### Case and cover

ALDC 12.1  
Silver gray painted

### Contact

Micro contact type  
One SPDT or two SPDT  
One DPDT

### Contact rating

- AC 125 V / 250 V, 15 A  
DC 125 V, 0.5 A for resistance load
- AC 125 V / 250 V, 15 A  
DC 125 V, 0.05 A for inductive load

### Conduit connection

½" PF (Single setpoint) P941  
¾" PF (Dual setpoint) P942

### Process connection

¾", ½" PT, NPT and PF

**WISE**<sup>®</sup>

**1. Base model**

- P941** Weatherproof type pressure switch (Single setpoint)
- P942** Weather proof type pressure switch (Dual setpoint)

**2. Unused character**

- 9B3** None

**3. Process connection**

- D** 3/8"
- E** 1/2"

**4. Connection type**

- B** PF
- C** PT
- D** NPT

**5. Measuring unit**

- X** Refer to pressure unit and range table

**6. Range**

- XXX** Refer to pressure unit and range table

**7. Pressure connection material**

- 3** 316SS

**8. Options**

- 0** None
- 1** Accessories

1	2	3	4	5	6	7	8
P941	9B3	D	B	X	XXX	3	0

Sample ordering code

## P94X : Type of mounting

Code P941

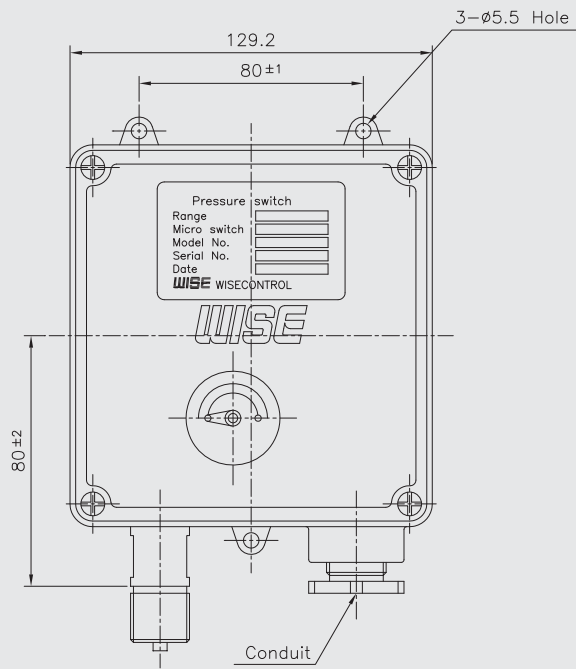

Code P942

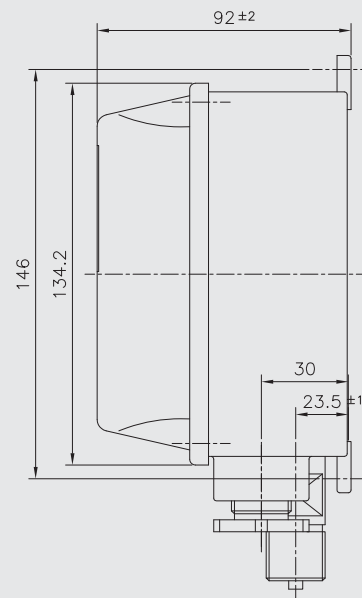
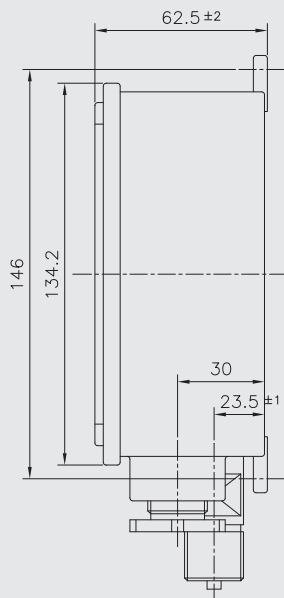
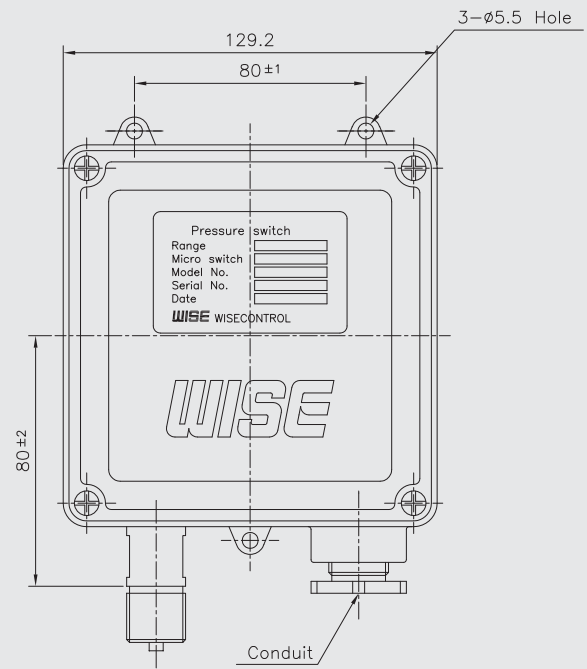

## Pressure unit and range table

Range and code	Unit and code		Model number	
	H : bar	I : MPa	P941	P942
026	-1 ~ 0	-0.1 ~ 0	O	O
041	0 ~ 1	0 ~ 0.1	O	O
042	0 ~ 2	0 ~ 0.2	O	O
043	0 ~ 3	0 ~ 0.3	O	O
044	0 ~ 4	0 ~ 0.4	O	O
045	0 ~ 6	0 ~ 0.6	O	O
047	0 ~ 10	0 ~ 1	O	O
050	0 ~ 15	0 ~ 1.5	O	O
051	0 ~ 20	0 ~ 2	O	O
052	0 ~ 25	0 ~ 2.5	O	O
054	0 ~ 35	0 ~ 3.5	O	O
055	0 ~ 50	0 ~ 5	O	O
057	0 ~ 70	0 ~ 7	O	O
058	0 ~ 100	0 ~ 10	O	O
059	0 ~ 150	0 ~ 15	O	O
062	0 ~ 250	0 ~ 25	O	O
064	0 ~ 350	0 ~ 35	O	O
027	-1 ~ 1	-0.1 ~ 0.1	O	O
028	-1 ~ 2	-0.1 ~ 0.2	O	O
029	-1 ~ 3	-0.1 ~ 0.3	O	O
030	-1 ~ 4	-0.1 ~ 0.4	O	O
031	-1 ~ 6	-0.1 ~ 0.6	O	O
032	-1 ~ 10	-0.1 ~ 1	O	O
033	-1 ~ 15	-0.1 ~ 1.5	O	O
034	-1 ~ 20	-0.1 ~ 2	O	O

O : Available    X : Not available